



## WIND / SUN SENSOR FOR AWNING

EOSUN-Hz

### SAFETY AND COMFORT FIRST

#### The **SUN SENSOR** automatically manages opening and closing of the awning:

- In case of strong wind, it will control the closing of the awning to protect it.
- When it is sunny, it orders the opening of the awning.
- The wind detection always has priority. Thus, in case of simultaneous sun and wind, it will order the closing of the awning to protect it.

**Easy installation:** EOSUN Hz is compatible with motors equipped with the SIMU-Hz radio control technology (see technical data overleaf). There is no wiring between the motor and EOSUN-Hz. It just needs to be wired to the electrical network.

#### New **REMOTE CONTROL SUN Hz 1 channel** to control remote an awning:

- Enables to activate or deactivate the sun detection function of the EOSUN-Hz sensor.

#### **LCD SCREEN:**

- Displays the current status of the sensor (SUN ON / SUN OFF).
- Alerts in case of weak battery.



CE



NEW

**simu-Hz**  
technology

## OPERATING PRINCIPLE OF EOSUN-HZ

### RELEASE IN CASE OF WIND:



The wind turns the anemometer. When the speed exceeds the threshold set by the installer for more than 2 seconds, EOSUN-Hz orders the motor to close the awning.

When the wind speed drops below the set threshold for more than 30 seconds, the awning can be deployed again. The «sun» function becomes active again after 12 min.

### RELEASE IN CASE OF SUN:

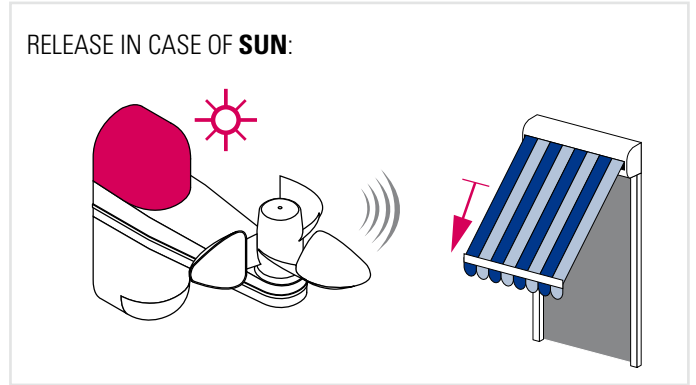

The intensity of the sun exceeds the threshold set by the installer for more than 2 minutes, EOSUN-Hz orders the motor to open the awning.

The wind detection function always has priority over sun detection. The security is privileged.

## TECHNICAL CHARACTERISTICS

### EOSUN-Hz

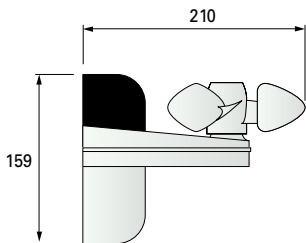

<b>PRODUCT CLASS</b>	class II
<b>POWER SUPPLY</b>	220-240 volts 50/60Hz
<b>AMBIANT TEMPERATURE OF USE</b>	-20°C / +50°C
<b>PROTECTION INDEX</b>	IP 34
<b>MOTOR COMPATIBILITY</b>	T3.5 Hz.02, T5 Hz.02, T6 Hz.02, DMI5 Hz.01, DMI6 Hz.01, T5ESP Hz et T6ESP Hz
<b>RADIO FREQUENCY</b>	433,42 MHz
<b>RANGE</b>	~ 200m in free field ~ 20m through 2 reinforced concrete walls (it depends of the environment and of the pollution)
<b>WIND SPEED THRESHOLD ADJUSTMENT</b>	from 10 to 50 Km/h
<b>SUNLIGHT INTENSITY THRESHOLD ADJUSTMENT</b>	from 0 to 50 Klux

### THE REMOTE CONTROL SUN-Hz 1 CHANNEL

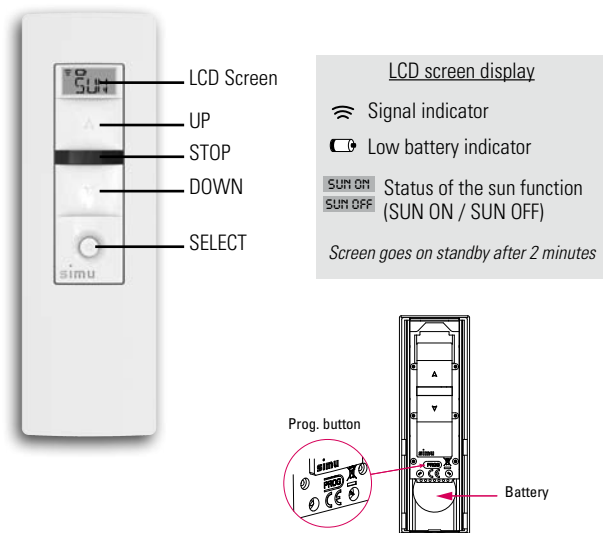

<b>POWER SUPPLY</b>	3V CR2430 battery
<b>PRODUCT CLASS</b>	class III
<b>AMBIANT TEMPERATURE OF USE</b>	-10°C / +60°C
<b>PROTECTION INDEX</b>	IP 30
<b>RADIO RANGE</b>	200 meters in open field and 20 meters through 2 reinforced concrete walls
<b>RADIO FREQUENCY</b>	433.42 MHz
<b>MOTOR COMPATIBILITY</b>	T3.5 Hz.02, T5 Hz.02, T6 Hz.02, DMI5 Hz.01, DMI6 Hz.01, T5 ESP Hz, T6 ESP Hz

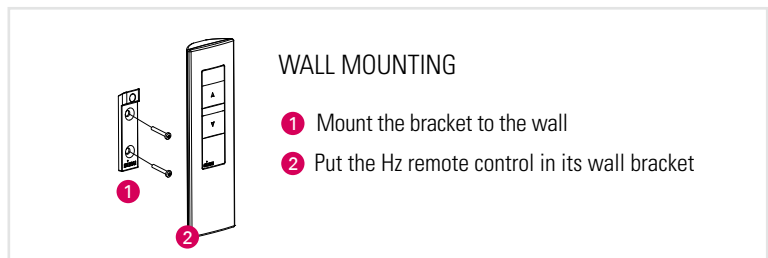

## REFERENCES

DESCRIPTION	REFERENCE
<b>EOSUN Hz</b>	<b>2005778</b>
<b>Remote control SUN Hz 1 channel</b>	<b>2008826</b>